

# 24658 PESCADERO ROAD

Carmel



**CARMEL REALTY COMPANY**  
ESTABLISHED 1913

— A Cornerstone in Luxury Real Estate for Over 100 Years —

PROPERTY DETAILS



APPROX. SQ. FOOTAGE

1,448 sq. ft.

BEDROOMS

Three

PRICE

\$1,200,000

APPROX LOT SIZE

12,400 sq. ft.

BATHROOMS

Two

WEBSITE

24658Pescadero.com

PROPERTY DESCRIPTION

**N**estled amongst the redwood and oak trees, dappled by sunlight, Squirrel Run offers a tranquil escape just minutes from downtown Carmel. Enjoy easy access to charming shops and restaurants, the renowned 17 Mile Drive into Pebble Beach, and the diverse activities of the Monterey area. Serene tree-top Pescadero Canyon views from the back deck beckons one to explore the entire large 12,400 sq ft lot, some of which is separated by cross-fencing and gates. Wood paneling, a wood burning fireplace, high vaulted ceilings and the kitchen updated approximately 20 years ago add to the hidden charm of this home. Wood floors appear to be under carpet in the living room and one bedroom. Located so close to everything, yet with that feeling of being removed from it all. Lots to do here with such great potential! Bring your contractor, your dreams and come consider the possibilities!

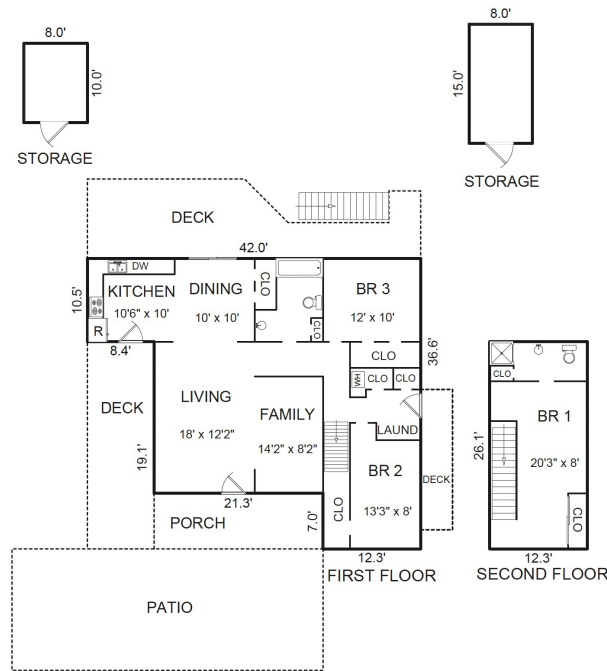

Square footage, acreage, and other information herein may have been received from a variety of sources and has not been verified. If important to buyers, buyers should conduct their own investigation.

CONTACT INFORMATION

**Rebecca Wolf Arnold**

831.241.2600

Rebecca@CarmelRealtyCompany.com

DRE# 01706104

**Danielle Germain**

Monterey Coast Realty

303.502.6477

Danielle@MontereyCoastRealty.com

DRE# 02154598

WWW.CARMELREALTYCOMPANY.COM



**CARMEL REALTY COMPANY**  
ESTABLISHED 1913



Dolores South of Seventh ■ P.O. Drawer C  
Carmel-by-the-Sea, California, 93921  
Office: 831.622.1000 ■ Fax: 831.624.7338