

# CASANOVA 8 NW OF OCEAN

Carmel-by-the-Sea



**CARMEL REALTY COMPANY**  
ESTABLISHED 1913

— A Cornerstone in Luxury Real Estate for Over 100 Years —



PROPERTY DETAILS



APPROX. SQ. FOOTAGE

2,020 sq. ft.

BEDROOMS

Three

PRICE

\$9,700,000

APPROX LOT SIZE

4,991 sq. ft.

BATHROOMS

Three Full & One Half

WEBSITE

TempleHouseCarmel.com

PROPERTY DESCRIPTION

"Temple House" - Brand New Construction in Carmel-by-the-Sea. 3 beds, 3.5 baths, plus family room. 2,020sqft on a 4,991sqft lot. Exceptional quality and design by Thomas Bateman Hood, Vance Killen Interiors, and construction by Brendan Connolly of Wayfinder Development. Large ipe decks on both levels. Enjoy radiant heat, quartzite & cesarstone counters, custom cabinets, and Thermador appliances. Soft contemporary exterior using stone, steel, and clear cedar siding. Two fire pits, an outdoor kitchen, and beautiful landscaping. Energy efficient and smart home features throughout including an induction cooktop and Energy Recovery Ventilator. Five minute walk to town, and a ten minute walk to Carmel Beach.

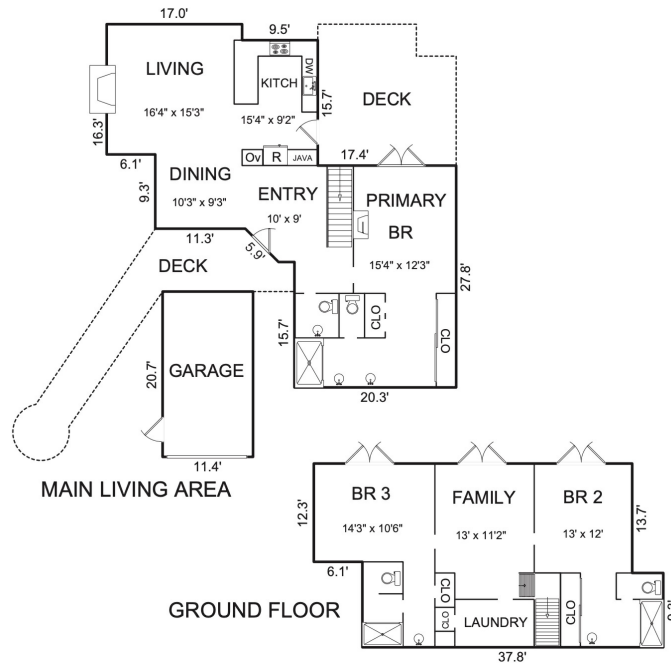

Square footage, acreage, and other information herein may have been received from a variety of sources and has not been verified. If important to buyers, buyers should conduct their own investigation.

CONTACT INFORMATION

**Ben Heinrich**

831.915.7415

Ben@heinrichbrooksher.com

DRE# 00584641

[www.heinrichbrooksher.com](http://www.heinrichbrooksher.com)

[www.CARMEIREALTYCOMPANY.COM](http://www.CARMEIREALTYCOMPANY.COM)



**CARMEIREALTY COMPANY**  
ESTABLISHED 1913



Dolores South of Seventh ■ P.O. Drawer C  
Carmel-by-the-Sea, California, 93921  
Office: 831.622.1000 ■ Fax: 831.624.7338