

# 41 SHEPHERD'S KNOLL

Pebble Beach



**CARMEL REALTY COMPANY**  
ESTABLISHED 1913

— A Cornerstone in Luxury Real Estate for Over 100 Years —

PROPERTY DETAILS



APPROX. SQ. FOOTAGE

2,241 sq. ft.

BATHROOMS

Three

BEDROOMS

Three

WEBSITE

41ShepherdsKnoll.com

PRICE

\$999,000

PROPERTY DESCRIPTION

**T**his inviting condo boasts a single-level design, ensuring easy access with no stairs at the entrance or within. Admire picturesque forest vistas from nearly every room. Spanning a generous 2,241 square feet, this home features three spacious bedrooms, three full baths, a convenient laundry room, well-appointed kitchen, inviting dining area, and a serene deck overlooking the enchanting Pebble Beach forest. Ample closet space and storage solutions abound throughout. For added convenience, enjoy a carport and nearby public parking, along with a sizable one-car garage. Nestled within the prestigious gated community of Shepherds Knoll in Pebble Beach, this residence offers proximity to Highway One, for quick access to shopping, dining, and amenities in Pebble Beach, Carmel, and the wider Monterey Peninsula.

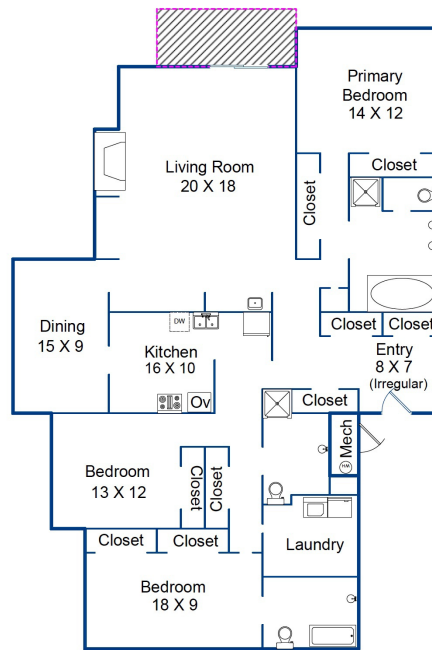

*Square footage, acreage, and other information herein may have been received from a variety of sources and has not been verified. If important to buyers, buyers should conduct their own investigation.*

CONTACT INFORMATION

**Steve LaVaute**

831.241.1434

Steve@CarmelRealtyCompany.com

DRE# 01372152

[www.stevelavaute.com](http://www.stevelavaute.com)

[WWW.CARMELREALTYCOMPANY.COM](http://WWW.CARMELREALTYCOMPANY.COM)



**CARMEL REALTY COMPANY**  
ESTABLISHED 1913



Dolores South of Seventh ■ P.O. Drawer C  
Carmel-by-the-Sea, California, 93921  
Office: 831.622.1000 ■ Fax: 831.624.7338