

# 40 SHEPHERD'S KNOLL

Pebble Beach



**CARMEL REALTY COMPANY**  
ESTABLISHED 1913

— A Cornerstone in Luxury Real Estate for Over 100 Years —

PROPERTY DETAILS



APPROX. SQ. FOOTAGE

1,927 sq. ft.

BEDROOMS

Three

PRICE

\$1,250,000

APPROX LOT SIZE

1,688 sq. ft.

BATHROOMS

Three

WEBSITE

40Shepherds.com

PROPERTY DESCRIPTION

**W**ith one of the best views possible in Shepherd's Knoll, this corner penthouse unit offers mesmerizing views, including the beach and curvature of the Monterey Bay, the bell tower of the Navy Postgraduate School, fairways of Del Monte Golf Course, airport take-offs and landings, the rolling hills of old Fort Ord and the mountains overlooking Salinas Valley to Fremont Peak. Facing east with corner windows to the south, the morning sunrise and early afternoon light give way to the twinkling lights of Monterey at night. One of only 10 penthouse corner units in the complex, there is a spacious great room with a high vaulted ceiling for living, dining and relaxing delight, along with three bedrooms, three full baths, plenty of storage and an in-unit laundry area. Carport parking and a private garage are close by.

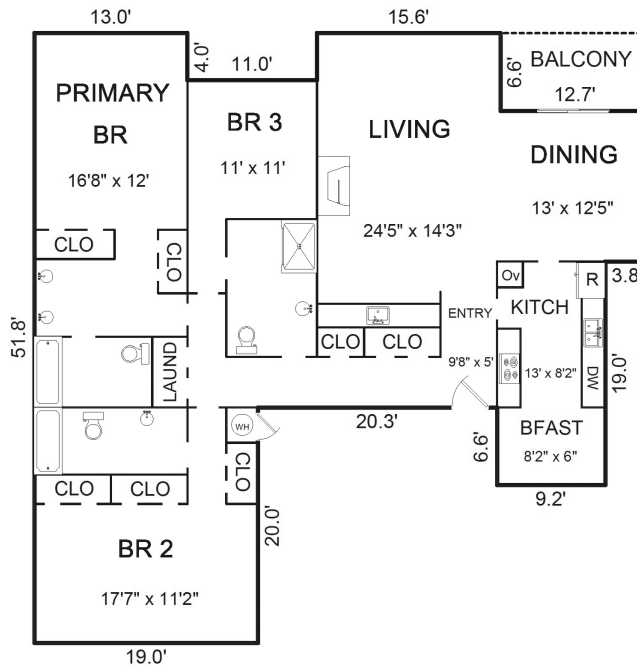

Square footage, acreage, and other information herein may have been received from a variety of sources and has not been verified. If important to buyers, buyers should conduct their own investigation.

CONTACT INFORMATION

**Jamal Noorzoy**

831.277.5544

Jamal@CarmelRealtyCompany.com

DRE# 01119622

[www.JamalNoorzoyLuxuryRE.com](http://www.JamalNoorzoyLuxuryRE.com)

[www.CARMEIREALTYCOMPANY.COM](http://www.CARMEIREALTYCOMPANY.COM)



**CARMEL REALTY COMPANY**  
ESTABLISHED 1913



Dolores South of Seventh ■ P.O. Drawer C  
Carmel-by-the-Sea, California, 93921  
Office: 831.622.1000 ■ Fax: 831.624.7338