

SAN ANTONIO 2 SW OF 10TH

Carmel-by-the-Sea



CARMEL REALTY COMPANY
ESTABLISHED 1913

— A Cornerstone in Luxury Real Estate for Over 100 Years —

PROPERTY DETAILS



APPROX. SQ. FOOTAGE

1,770 sq. ft.

APPROX LOT SIZE

4,000 sq. ft.

BEDROOMS

Three

BATHROOMS

Two Full & One Half

PRICE

\$6,850,000

WEBSITE

SanAntonio2SW10th.com

PROPERTY DESCRIPTION

Stunning panoramic views welcome you to this sunny Carmel beach house on the sought after west side of San Antonio Ave. Aptly named Crow's Nest, this home features an ocean view balcony off the living room and additional roof top deck off the primary suite giving you spectacular views above the rest. Views from Point Lobos to the Pebble Beach Golf Links and the white sands of Carmel Beach. Beautiful mature gardens front and back, one car garage, 3 bedroom, 2.5 bath, this is the perfect Carmel getaway. Just steps to the beach and easy stroll to downtown shopping, galleries and restaurants.

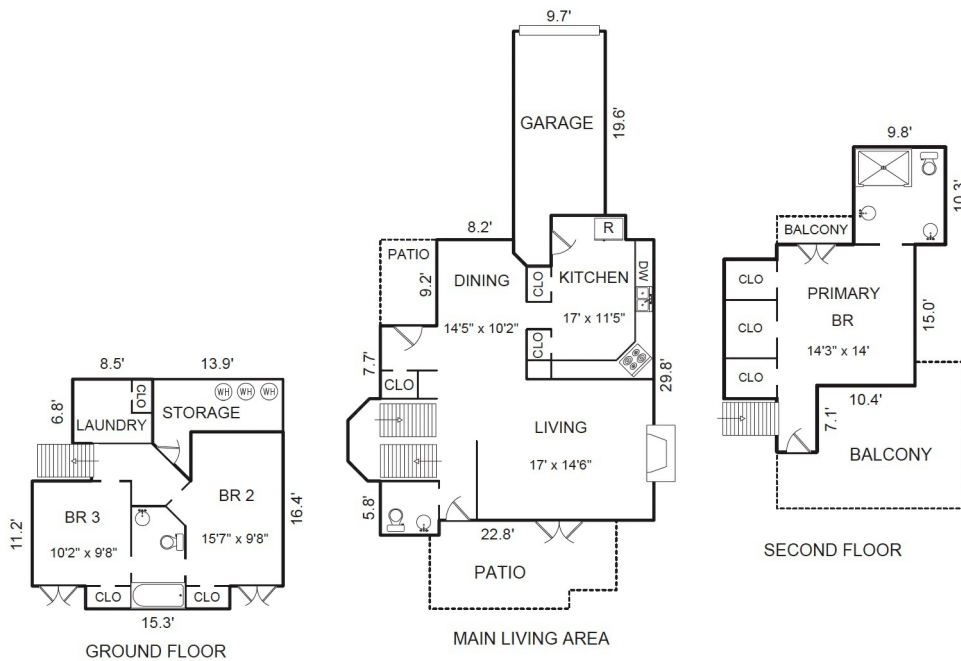

Square footage, acreage, and other information herein may have been received from a variety of sources and has not been verified. If important to buyers, buyers should conduct their own investigation.

CONTACT INFORMATION

Shelly Mitchell Lynch

831.277.8044

Shelly@CarmelRealtyCompany.com

DRE# 01217466

Vicki Mitchell

831.277.3105

Vicki@CarmelRealtyCompany.com

DRE# 00541827

WWW.CARMELREALTYCOMPANY.COM



CARMEL REALTY COMPANY
ESTABLISHED 1913



Dolores South of Seventh ■ P.O. Drawer C
Carmel-by-the-Sea, California, 93921
Office: 831.622.1000 ■ Fax: 831.624.7338