

3896 RONDA ROAD

Pebble Beach



CARMEL REALTY COMPANY
ESTABLISHED 1913

— A Cornerstone in Luxury Real Estate for Over 100 Years —

PROPERTY DETAILS



APPROX. SQ. FOOTAGE

3,543 sq. ft.

BEDROOMS

Four

PRICE

\$5,475,000

APPROX LOT SIZE

0.67 acres

BATHROOMS

Four

WEBSITE

3896Ronda.com

PROPERTY DESCRIPTION

This private gated mid-century modern home in Pebble Beach boasts ocean and golf course views. Situated on .67 acres above The Hay Golf Course, it offers vistas of Point Lobos, Carmel Bay, and the open ocean. The open floor plan includes three large bedroom suites in the main house and a fourth suite with a private entrance below. Floor-to-ceiling windows in the great room lead to a large deck, blending indoor and outdoor living for entertaining. The home features a bright spacious kitchen, a sizable office or den, and a versatile bonus room for a gym, game room, or storage. Surrounded by mature gardens and coastal oaks, the property borders a path to The Hay, offering a central location minutes from The Lodge, Beach Club, and golf courses—a perfect Pebble Beach retreat for the quintessential coastal lifestyle.

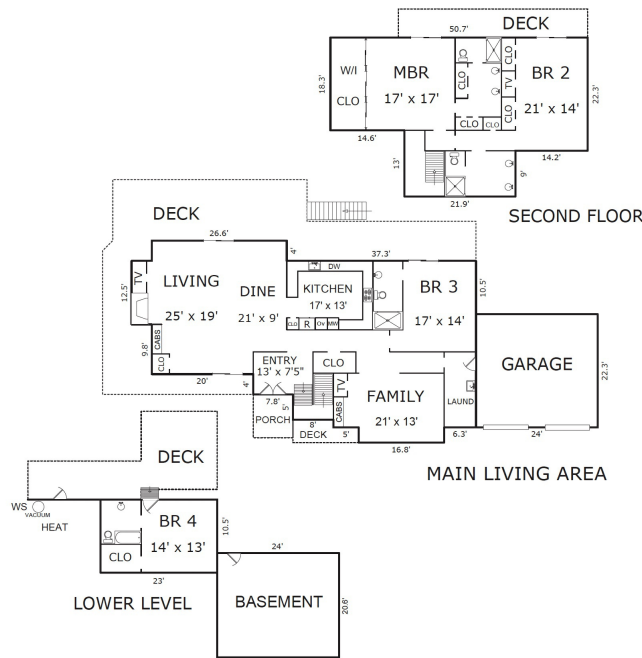

Square footage, acreage, and other information herein may have been received from a variety of sources and has not been verified. If important to buyers, buyers should conduct their own investigation.

CONTACT INFORMATION

Shelly Mitchell Lynch

831.277.8044

Shelly@CarmelRealtyCompany.com

DRE# 01217466

www.mitchellgroup.com

WWW.CARMELREALTYCOMPANY.COM



CARMEL REALTY COMPANY
ESTABLISHED 1913



Dolores South of Seventh ■ P.O. Drawer C
Carmel-by-the-Sea, California, 93921
Office: 831.622.1000 ■ Fax: 831.624.7338