

PROPERTY FLOOR PLAN

File No.

SUBJECT	Property Address	Comerboa Building						
	City	Carmel	State	California	County	Monterey	Zip Code	93921
	Borrower	Greg Kraft						
	Lender/Client	Dal Monte Realty Company						

IMPROVEMENTS SKETCH

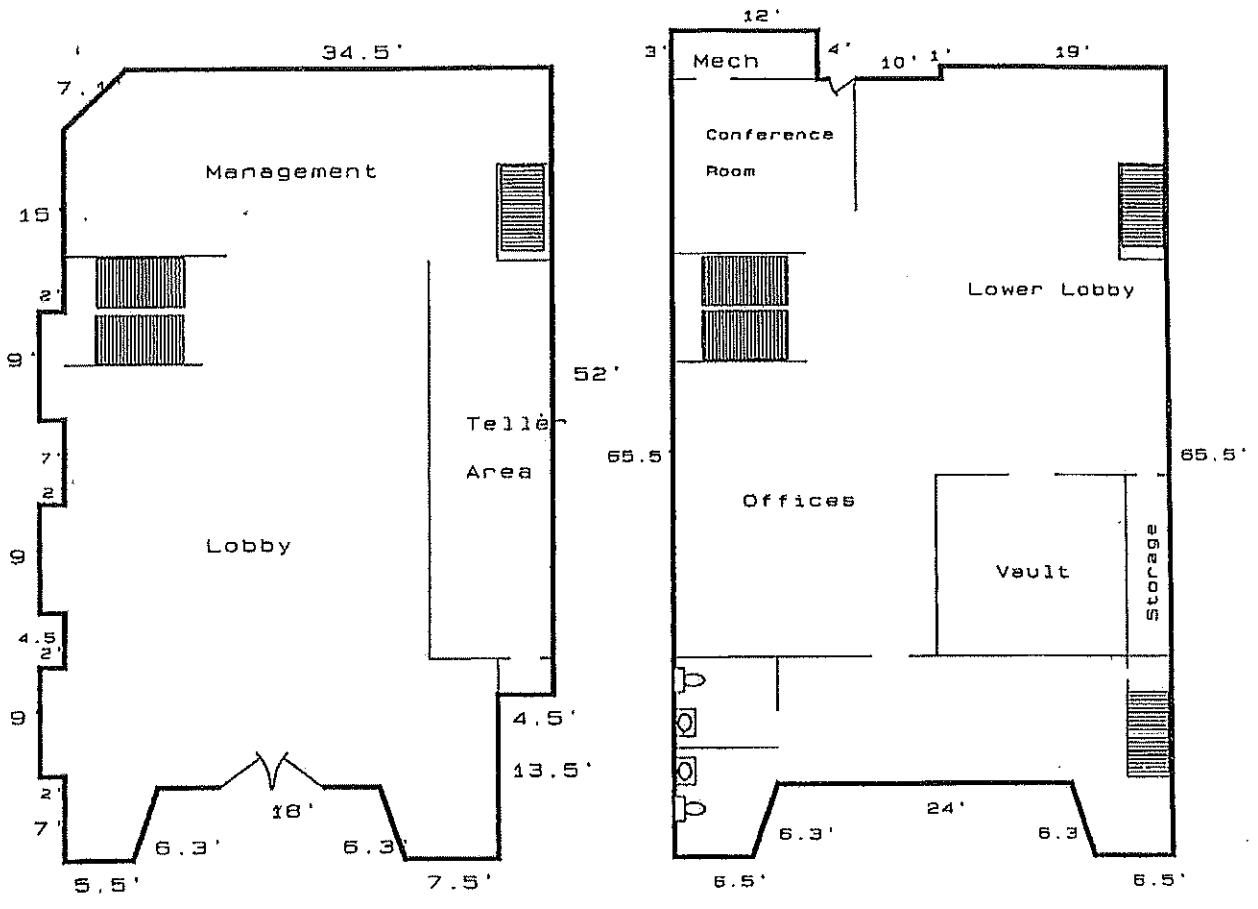

SCALE: 1 inch = 15.00 feet

AREA CALCULATIONS

AREA CALCULATIONS SUMMARY			
Area	Name of Area	Size	Totals
GLA1	Bank Lobby	2448.00	2448.00
GLA2	Lower Level	2555.50	2555.50
TOTAL LIVABLE (rounded)			5004

LIVING AREA CALCULATIONS		
	Breakdown	Subtotals
	5.00 X 65.50	327.50
	34.50 X 65.50	2259.75
	2.00 X 45.50	91.00
	-2.00 X 36.50	-73.00
	2.00 X 29.50	59.00
	-2.00 X 20.50	-41.00
	2.00 X 16.00	32.00
	-4.50 X 13.50	-60.75
	-2.00 X 7.00	-14.00
	-18.00 X 6.00	-108.00
	-1.00 X 6.00	-6.00
	-1.00 X 6.00	-6.00
	-2.50 X 5.00	-12.50
	41.00 X 68.50	2808.50
	-19.00 X 3.00	-57.00
	-10.00 X 4.00	-40.00
	1° X 156.00	-156.00
5004		5004