

218 BENTLEY STREET

Pacific Grove



CARMEL REALTY COMPANY
ESTABLISHED 1913

— A Cornerstone in Luxury Real Estate for Over 100 Years —

PROPERTY DETAILS



APPROX. SQ. FOOTAGE

2,519 sq. ft.

BEDROOMS

Three

PRICE

\$2,200,000

APPROX LOT SIZE

8,300 sq. ft.

BATHROOMS

Two

WEBSITE

218BentleyStPG.com

PROPERTY DESCRIPTION

Fabulous Craftsman style, single story home awaits its new owner! Enjoy periodic views of whales in the Bay from the kitchen nook, living room and outdoor patio high top. Exposed wood, plastered walls, large windows and stained glass give the home a charming elegance. The architecture is highlighted by an open floor plan, high ceilings, and wooden accents throughout. The primary suite has a large comfortable seating area by the fireplace and oversized jetted tub. Each bedroom features French door access to an inviting central patio perfect for relaxing around the natural gas firepit or soaking in the new hot tub. Thoughtfully landscaped with a mixture of hardscape and water-efficient softscape, the plants, shrubs and trees maximize home and yard privacy while leaving plenty of parking and access to the 2-car garage. Fenced backyard with electronic driveway gate provides security and room for pets to run. Lots of upgrades and improvements have been made to this warm and welcoming home.

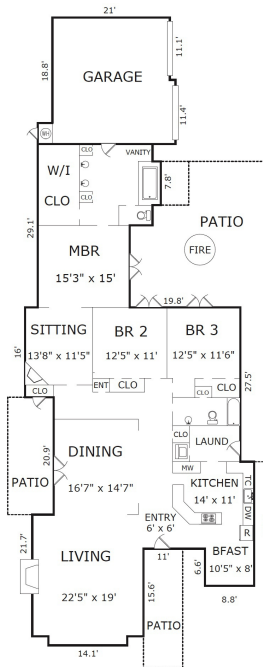

Square footage, acreage, and other information herein may have been received from a variety of sources and has not been verified. If important to buyers, buyers should conduct their own investigation.

CONTACT INFORMATION

Rebecca Wolf Arnold

831.241.2600

Rebecca@CarmelRealtyCompany.com

DRE#01706104

Geoff Arnold

831.297.3890

Geoff@CarmelRealtyCompany.com

DRE#02036451

Danielle Germain

Monterey Coast Realty

303.502.6477

Danielle@MontereyCoastRealty.com

DRE#02154598

WWW.CARMELOREALTYCOMPANY.COM



CARMEL REALTY COMPANY
ESTABLISHED 1913



Dolores South of Seventh ■ P.O. Drawer C
Carmel-by-the-Sea, California, 93921
Office: 831.622.1000 ■ Fax: 831.624.7338