

27645 SCHULTE ROAD

Carmel



CARMEL REALTY COMPANY
ESTABLISHED 1913

— A Cornerstone in Luxury Real Estate for Over 100 Years —

PROPERTY DETAILS



APPROX. SQ. FOOTAGE

2,948 sq. ft.

BEDROOMS

Five

PRICE

\$1,995,000

APPROX LOT SIZE

11.5 acres

BATHROOMS

Three

WEBSITE

27645SchulteRoad.com

PROPERTY DESCRIPTION

There is nothing like it: a secluded 11 acre hillside estate in Carmel Valley. On the approach to the property, one drives past ranches and pastures turning left up a private road, flanked by live oaks. The main house sits at the top with a breathtaking view across Carmel Valley, as well as for miles both up and down it. The post adobe structure is casual and warm with 5 bedrooms, 2 1/2 baths, 2 laundry rooms, 4 wood-burning fireplaces. Separate guest house with deck and fabulous views. Pool with pool house and outstanding poolside area for lounging or partying: hot tub, vast gardens, vineyard. Barn and several out-buildings. Downtown Carmel is ten minutes away. Carmel Valley Village 10 minutes. You're in the world, but not of it, and all the noise and worry stop at the gate, where this magnificent property, and all it carries with it, begin. It's a space thats perfect for any kind of entertaining, from a small dinner to a big wedding, or anything in between.

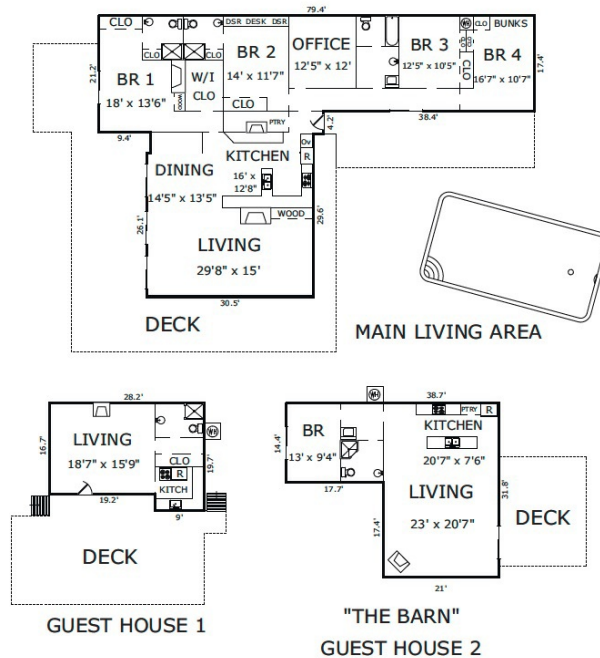

Square footage, acreage, and other information herein may have been received from a variety of sources and has not been verified. If important to buyers, buyers should conduct their own investigation.

CONTACT INFORMATION

Paul Brocchini

831.601.1620

PaulB@CarmelRealtyCompany.com

DRE# 00904451

Mark Ryan

831.238.1498

MarkRyan@CarmelRealtyCompany.com

DRE# 01458945

WWW.CARMELREALTYCOMPANY.COM



CARMEL REALTY COMPANY
ESTABLISHED 1913



Dolores South of Seventh ■ P.O. Drawer C
Carmel-by-the-Sea, California, 93921
Office: 831.622.1000 ■ Fax: 831.624.7338