

# 152 13TH STREET

Pacific Grove



**CARMEL REALTY COMPANY**  
ESTABLISHED 1913

— A Cornerstone in Luxury Real Estate for Over 100 Years —

PROPERTY DETAILS



APPROX. SQ. FOOTAGE

1,704 sq. ft.

BEDROOMS

Three

PRICE

\$1,995,000

APPROX LOT SIZE

2,700 sq. ft.

BATHROOMS

Two

WEBSITE

152-13thStPG.com

PROPERTY DESCRIPTION

**V**ibrant. Verdant. Peaceful. This charming 2-story contemporary home is steps from downtown PG and less than two blocks to the Rec Trail and the Pacific Ocean! You'll fall in love with the gorgeous hardwood floors, the warm, custom-colored walls and the Zen-like feeling throughout. Bright, natural light fills the living and dining room, featuring a vaulted ceiling, bay window and fireplace. The kitchen comes equipped with a Wolf range and Sub-Zero fridge. Enjoy a main floor bedroom with adjoining bathroom or take advantage of two vaulted ceiling bedrooms upstairs, both with ample closet space. A full bathroom, laundry closet with Miele washer/dryer and a "secret nook," perfect for extra storage or quiet study, complete the upstairs. The private, fully-fenced backyard is a personal refuge of flowering vines draping over the sleek cabling atop redwood fencing, gorgeous Turkish pavers, and hot tub. The attached 2-car garage includes built-in storage, work bench, EV charger and 2 Tesla Powerwalls, providing solar power efficiency! A modern sanctuary in downtown PG, this turn-key beauty has it all!

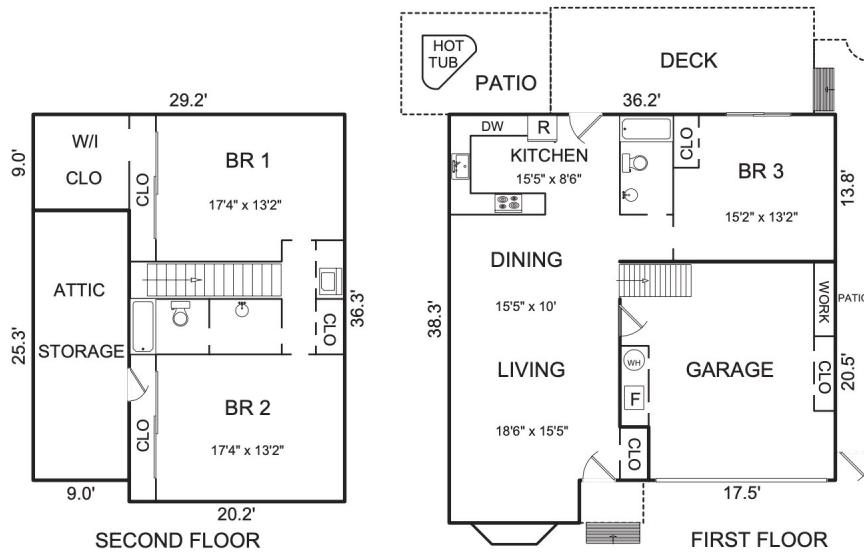

*Square footage, acreage, and other information herein may have been received from a variety of sources and has not been verified. If important to buyers, buyers should conduct their own investigation.*

CONTACT INFORMATION

**Geoff Arnold**

831.297.3890

Geoff@CarmelRealtyCompany.com

DRE# 02036451

**Rebecca Wolf Arnold**

831.241.2600

Rebecca@CarmelRealtyCompany.com

DRE# 01706104

WWW.CARMEALREALTYCOMPANY.COM



**CARMEL REALTY COMPANY**  
ESTABLISHED 1913



Dolores South of Seventh ■ P.O. Drawer C  
Carmel-by-the-Sea, California, 93921  
Office: 831.622.1000 ■ Fax: 831.624.7338