

Warm Modern Oceanfront

3188 17 Mile Drive | Pebble Beach



CARMEL REALTY COMPANY
ESTABLISHED 1913

A CORNERSTONE IN LUXURY REAL ESTATE FOR OVER 100 YEARS

PROPERTY DETAILS

APPROX. SQ. FOOTAGE

7,650 sq. ft.

APPROX. LOT SIZE

1.5 Acres

BEDROOMS

Six

BATHROOMS

Six Full & Two Half

PRICE

\$26,500,000

WEBSITE

www.3188SeventeenMileDrive.com

DESCRIPTION

A perfect pairing of extraordinary architecture and striking natural beauty come together in the heart of Pebble Beach's most exclusive front line. Peppared with legacy estates with names like Bechtel, Morse and Crocker, this new warm modern masterpiece is one of only 31 oceanfront estates along the coveted 17 Mile Drive. The scene is like no other in the world, set by the everchanging Pacific Ocean and shaped by a pristine rocky coastline with granite boulders aged by centuries of surf and framed by magnificent Cypress trees. Majestic generational homes of this caliber and in this setting, rarely come to market. Close to Cypress Point, this estate sits in very close proximity to The Lodge at Pebble Beach, Carmel-by-the-Sea, and host of 5 star amenities. Designed with breathtaking views from nearly every room in the house, there are six bedroom suites, six full and two half bathrooms, wine cellar, art gallery, huge chefs kitchen, over 1000 sq ft of ocean front terraces, generous 3 car garage on approximately 1.5 acres with over 200 feet of ocean frontage and epic sunsets. Experience this magical estate.

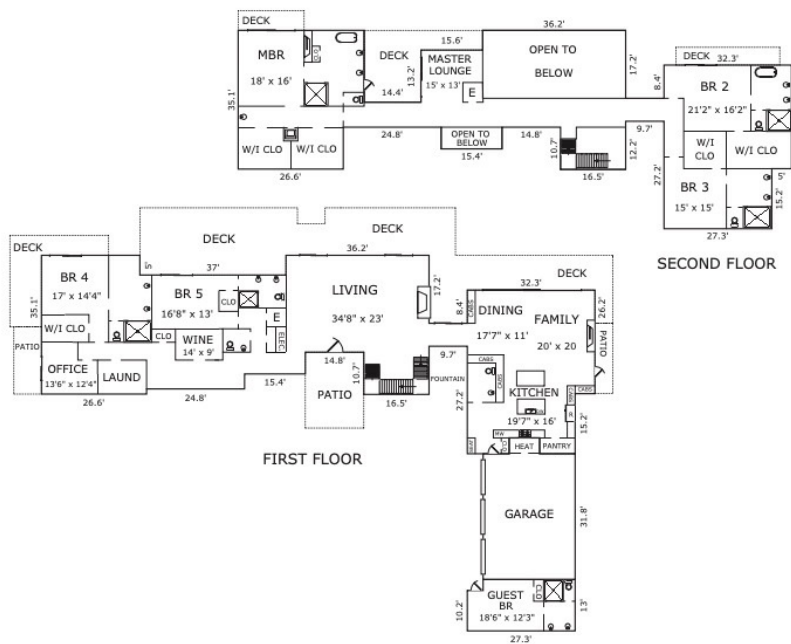

CONTACT INFORMATION

Shelly Mitchell Lynch

831.277.8044

Shelly@CarmelRealtyCompany.com

DRE# 01217466

Vicki & Bill Mitchell

831.277.3105

Vicki@CarmelRealtyCompany.com

DRE# 00541827



CARMEL REALTY COMPANY
ESTABLISHED 1913



Dolores South of Seventh · PO Drawer C
Carmel-by-the-Sea, California 93921
Office: 831.622.1000 · Fax: 831.624.7338