

27993 MERCURIO ROAD, CARMEL, CA 93923

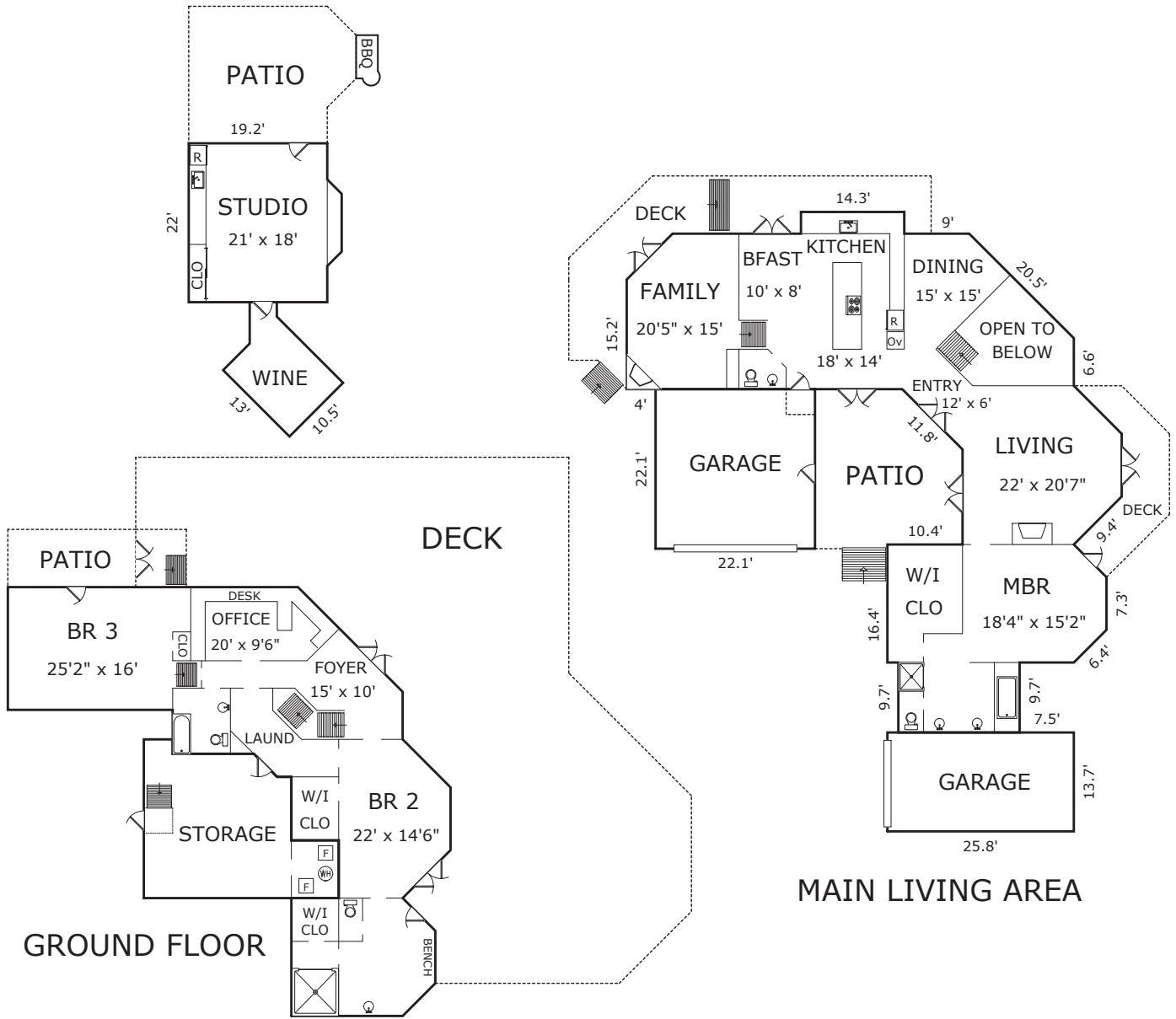

AREA CALCULATIONS

Main Living Area:	2,172sf
Ground Floor:	1,693
Studio:	443
Net Livable Area:	4,308sf

Garage:	488	Garage:	354
Wine:	151	Storage:	459
Patio:	411	Patio:	405
Patio:	142	Deck:	2,785
Deck:	462	Deck:	179